

CHECKSTANDS

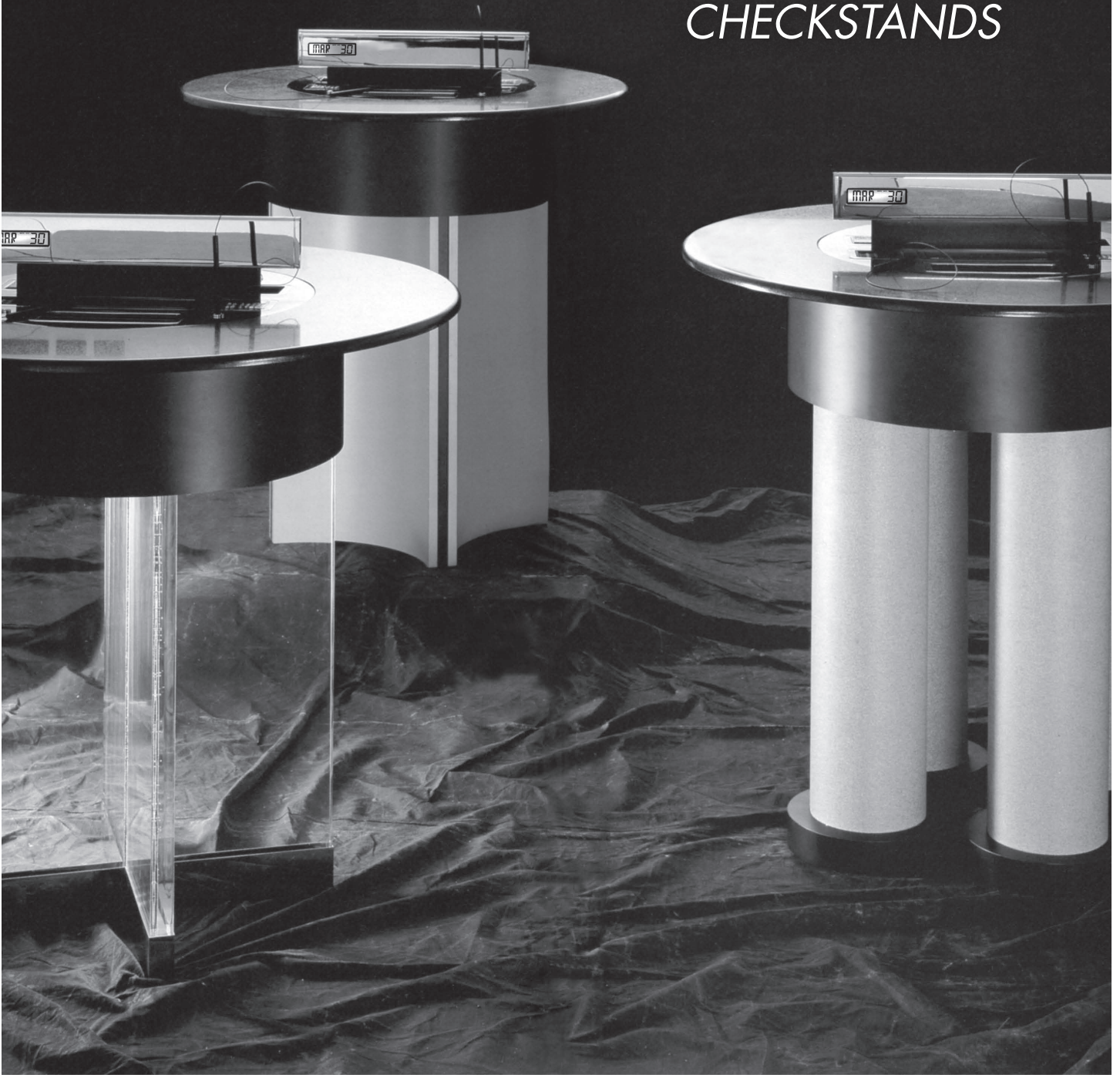

METCOR

CHECKSTANDS

Estimated
Shipping Weight
(in pounds)

LIST PRICE

Metcor offers the largest collection of catalogued and A.D.A. compliant checkstands which arrive pre-assembled and ready for instant use. Our ADA compliant checkstands service disabled clients without segregation from able-bodied clients. Metcors checkstands can be modified or completely custom designed to fit your special requirements. Designers can specify his or her choice of accessories, along with a vast array of surface treatments. By utilizing any metal, laminate, wood, marble or granite, our designs provide a variety of choices to suit any budget. Metcor began its "design your own" concept in 1962 and has continued our tradition of helping you to bring your concepts to reality by offering custom manufacturing.

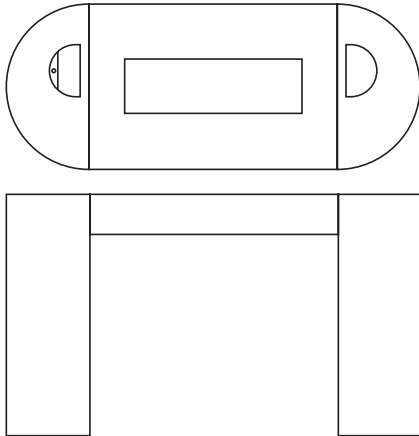

CS7001

Oval checkstand (not shown in catalog)
Specify laminate granite or marble
Components: CC2410S (pp. 26), W2402 (pp. 32),
Q2404 (pp.32)
Additional Features: Waste and quick deposit
receptacle (pp. 32),
2 locking doors in pedestals.

450

Call for Pricing

SIZE: 60"L x 24"W x 40"H

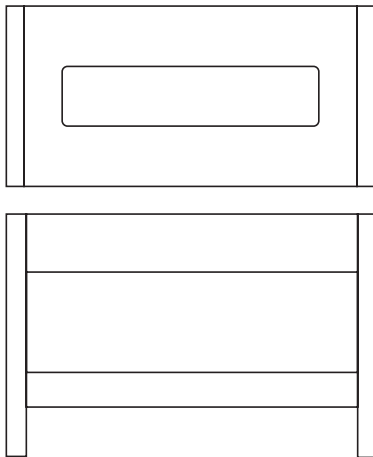

CS7130

Rectangular checkstand (as shown in catalog on
page 3)
Writing Surface: Plastic laminate
Vertical Surface(s): Oak veneer
Components: CC2351S (pp. 27)
Additional Features: none

400

Call for Pricing

SIZE: 60"L x 30"W x 40"H

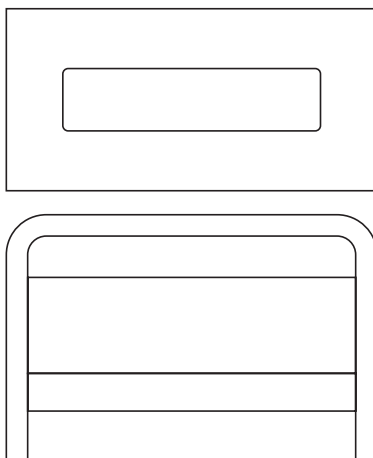

CS7131

(as shown in catalog on page 3)
Hardwood veneer with plastic laminate accents
Components: CC2531S (pp. 27)
Additional Features: none

400

Call for Pricing

SIZE: 60"L x 30"W x 40"H

CHECKSTANDS

Estimated
Shipping Weight
(in pounds)

LIST PRICE

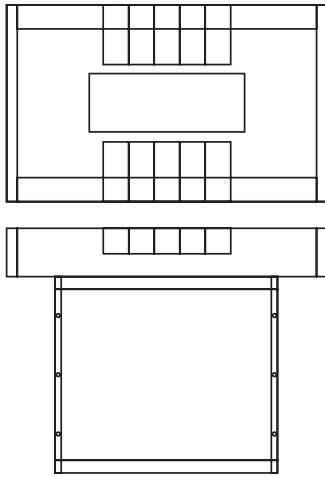

CS7004

Oval Checkstand (as shown in catalog on page 3)
Writing Surface: Glass
Vertical Surface(s): Plastic laminate/stainless steel
Components: CC3346 (pp 11)
Additional Features: 10 form holders, with waste receptacles.

SIZE: 60"L x 30"W x 40"H

350

Call for Pricing

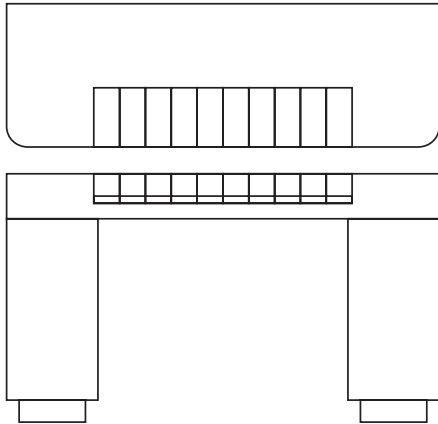

CS7006

Rectangular checkstand (not shown in catalog)
Writing Surface: Plastic laminate
Vertical Surface(s): Plastic laminate with aluminum tambour
Components: CC2302R (pp. 18), W2401 (pp. 31), Q2403 (pp. 31)
Additional Features: 10 form holder pockets, two locking doors

SIZE: 72"L x 24"W x 40"H

500

Call for Pricing

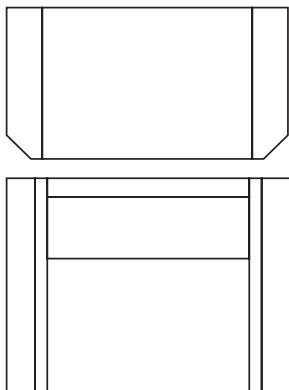

CS7010

Rectangular single sided checkstand for handicapped (not shown in catalog)
Writing Surface: Plastic laminate
Vertical Surface(s): Plastic laminate
Components: CC2301S (pp. 25)
Additional Features: Optional doors

SIZE: 46"L x 24"W x 32"H

275

Call for Pricing

CHECKSTANDS

Estimated
Shipping Weight
(in pounds)

LIST PRICE

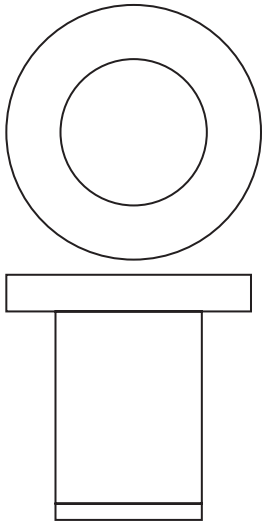

CS7002

Round checkstand without door (as shown in catalog, page 3)
 Writing Surface: Black granite
 Vertical Surface(s): Black plastic laminate/stainless steel
 Components: CC2422R (pp. 20)
 Additional Features: CS7002D (optional) same as 7002 with door and lock

SIZE: 42"D x 40"H

300

Call for Pricing

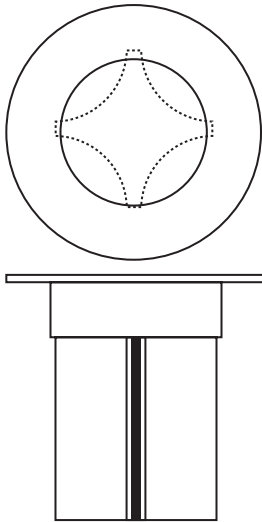

CS7121

Round checkstand (as shown in catalog on page 2)
 Writing Surface: Black Andes granite with black laminate skirt
 Vertical Surface(s): Plastic laminate with black trim
 Components: CC2422R (pp. 20)
 Additional Features: none

SIZE: 42"D x 40"H

400

Call for Pricing

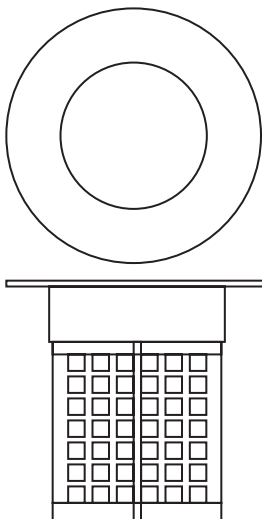

CS7122

Round checkstand (as shown in catalog on page 2)
 Writing Surface: Black Andes granite with black laminate skirt
 Vertical Surface(s): Painted hardwood base
 Components: CC2422R (pp. 26)
 Additional Features: none

SIZE: 42"D x 40"H

350

Call for Pricing

CHECKSTANDS

Estimated
Shipping Weight
(in pounds)

LIST PRICE

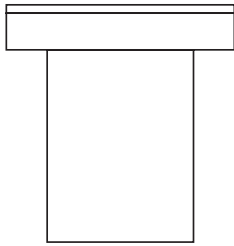
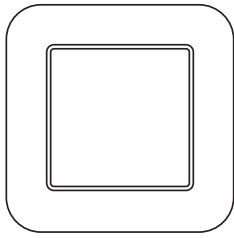

CS7127

Square checkstand with radius corners (as shown in catalog on page 3)

Writing Surface: Verde marble with brass reveal

Vertical Surface(s): Hardwood tambour

Components: CC2324 (pp. 19)

Additional Features: Optional waste door (7009D)

SIZE: 42"L x 42"W x 40"H

400

Call for Pricing

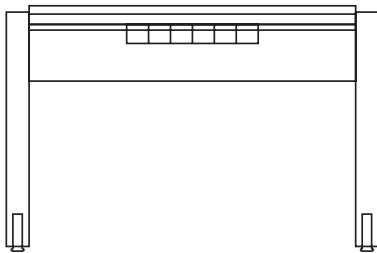
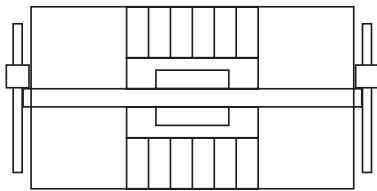

CS7008

Rectangular checkstand (not shown in catalog)

Writing Surface: Specify

Vertical Surface(s): Stainless steel

Components: CC2305S (pp. 24)

Additional Features: Optional waste door (7009D)

SIZE: 60"L x 36"W x 40"H

400

Call for Pricing

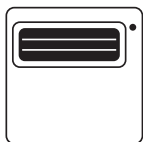

CS6000

SIZE: 12"L x 12"W x 3 1/2"H

15

Call for Pricing

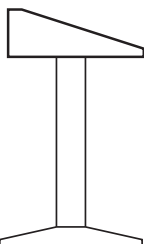
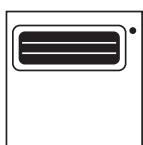

CS6010

SIZE: 12"L x 12"W x 40"H

25

Call for Pricing